

Q1:



My primary reason for visiting Recreation.gov today was to...

Research a future trip

Reserve a Campsite/RV

Purchase Tickets/Tours

Purchase Annual Pass

Purchase Recreation Activities/Permits

Modify/Cancel current reservation

Other...

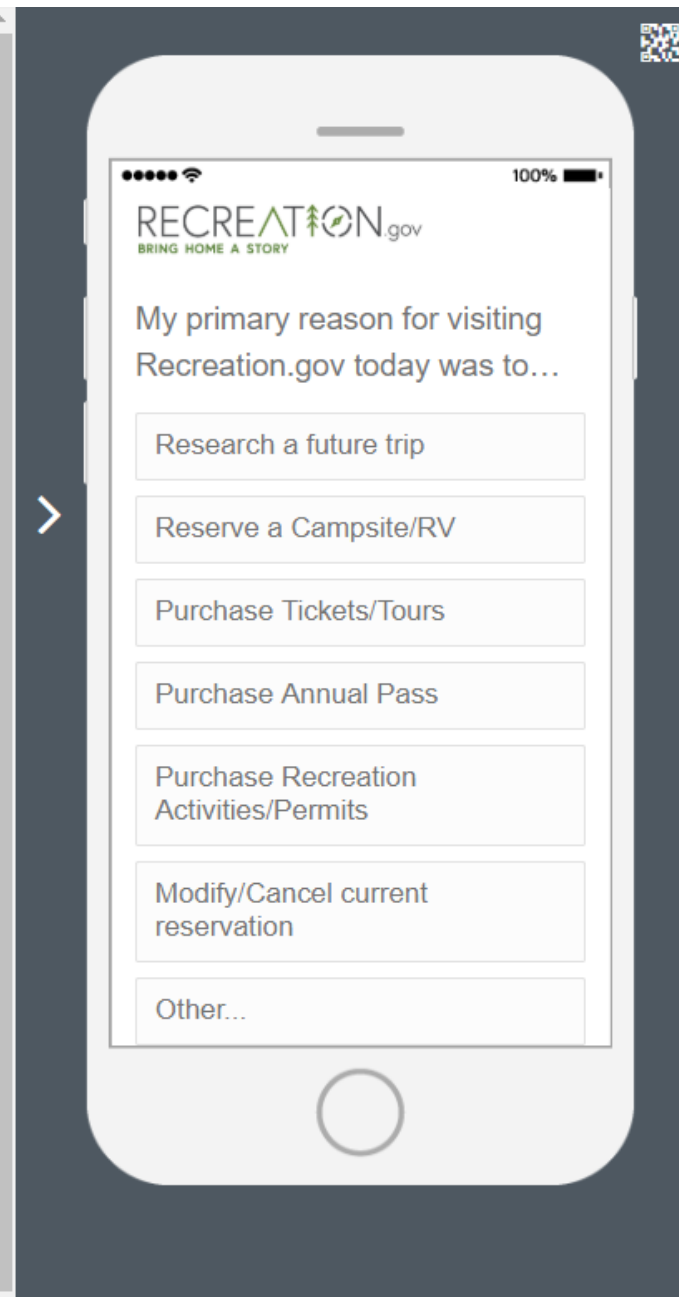

Q1-a: If "Other..." is selected from Q1



What was your primary reason for visiting Recreation.gov today?

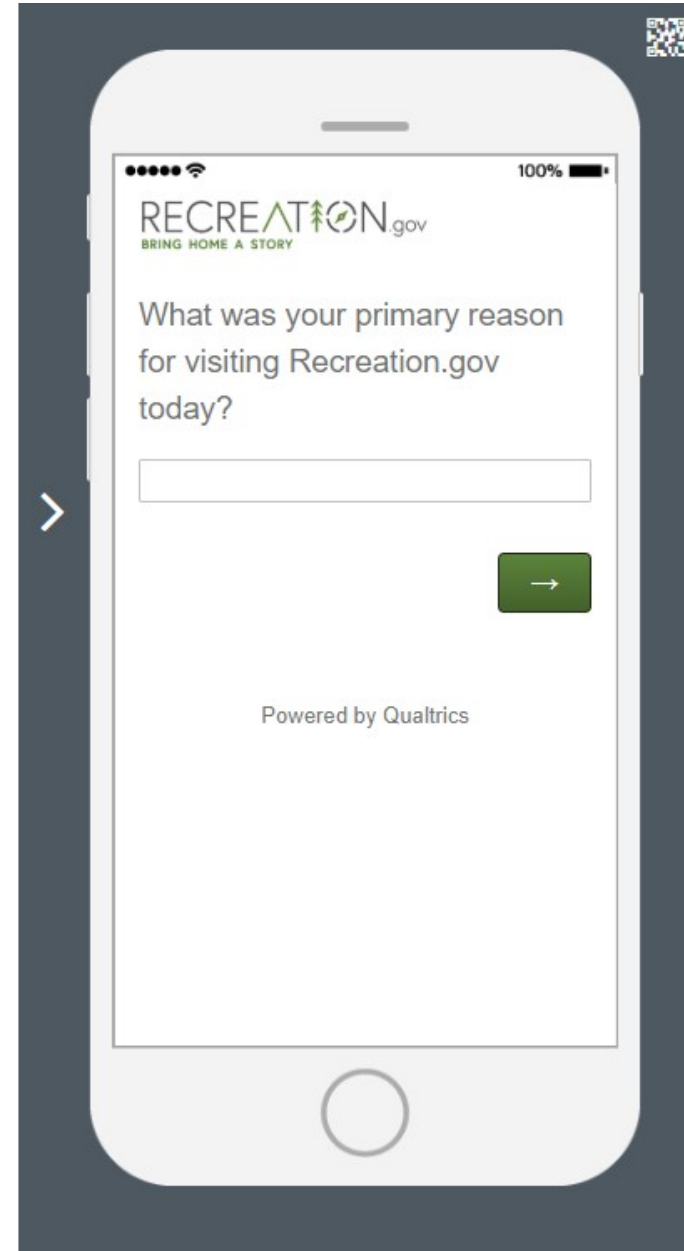

Q2:



Please response with you level of agreement with the following statements based on your visit to Recreation.gov today:

	Strongly Disagree	Disagree	Neutral	Agree	Strongly Agree
Q2-a I am satisfied with the service I received from Recreation.gov	<input type="radio"/>	<input type="radio"/>	<input type="radio"/>	<input type="radio"/>	<input type="radio"/>
Q2-b This interaction increased my confidence in Recreation.gov	<input type="radio"/>	<input type="radio"/>	<input type="radio"/>	<input type="radio"/>	<input type="radio"/>
Q2-c I was able to accomplish what I wanted to do on Recreation.gov today	<input type="radio"/>	<input type="radio"/>	<input type="radio"/>	<input type="radio"/>	<input type="radio"/>
Q2-d It was easy to complete what I needed to do	<input type="radio"/>	<input type="radio"/>	<input type="radio"/>	<input type="radio"/>	<input type="radio"/>

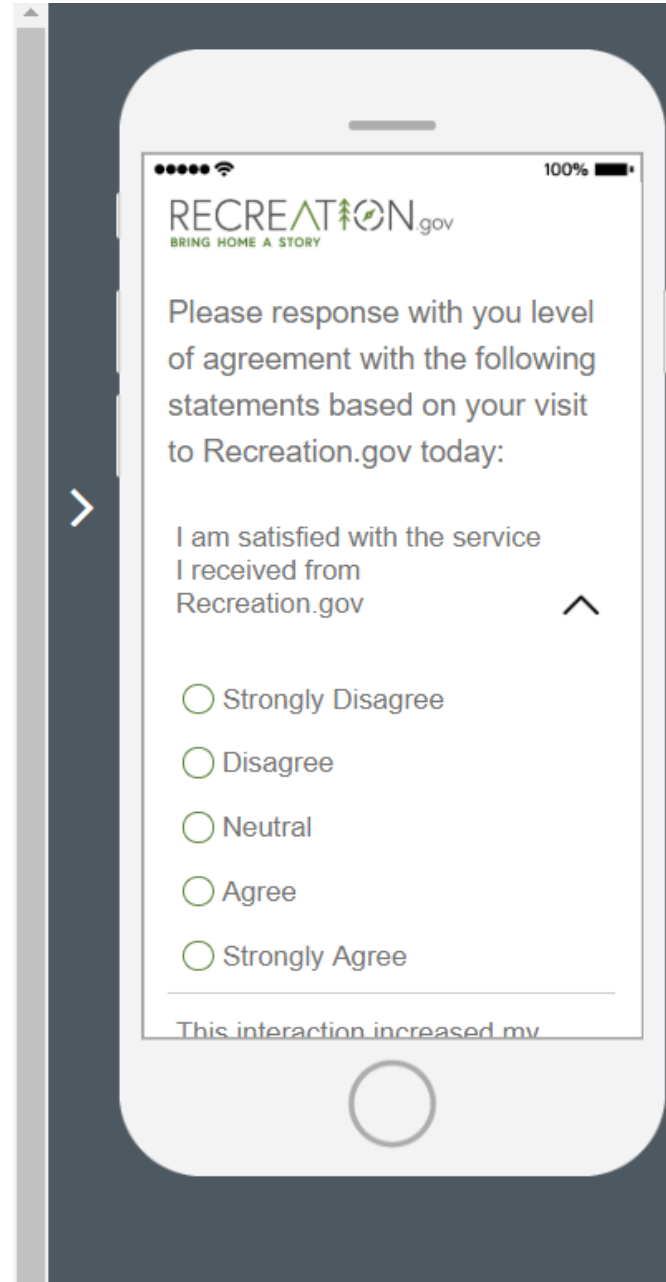

Q2-e: If “Strongly Disagree,” “Disagree,” or “Neutral” are selected in response to Q2-c.



I was unable to accomplish what I came here to do today because of...

- Technical issues with the website
- Confusing checkout process
- The item I wanted was unavailable
- Difficulty logging in
- Finding the information I'm looking for
- Other...

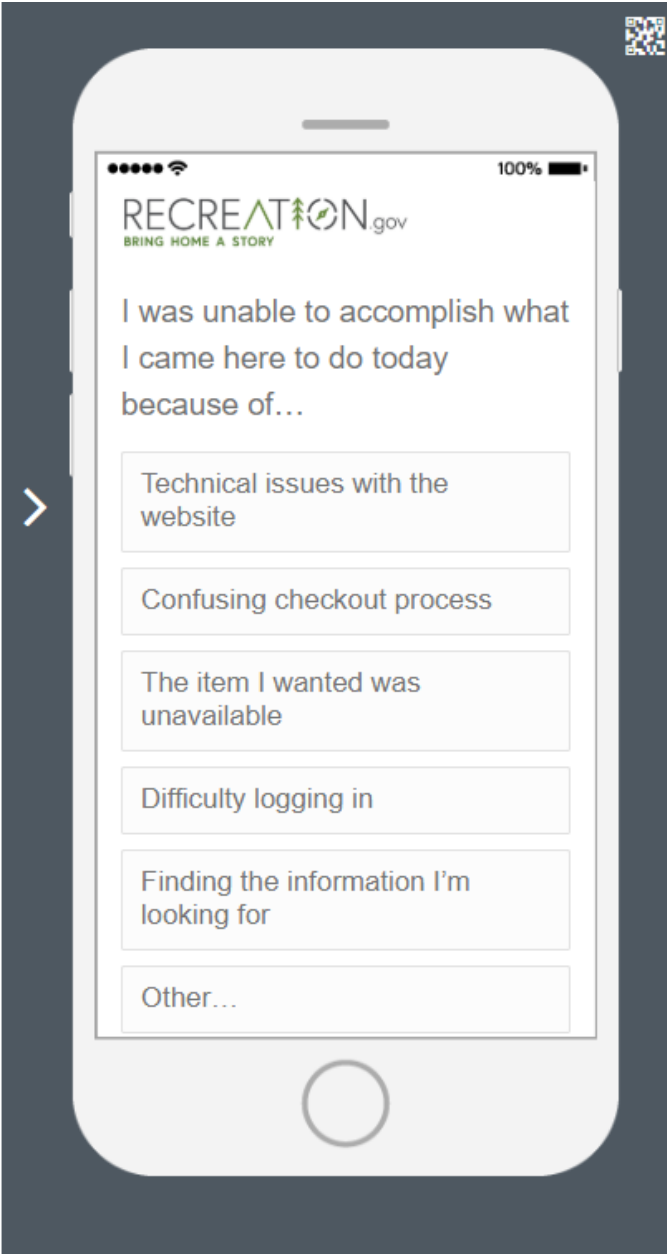

Q2-f: If "Other..." is selected in response to Q2-e.



What made you unable to accomplish what you came here to do today?

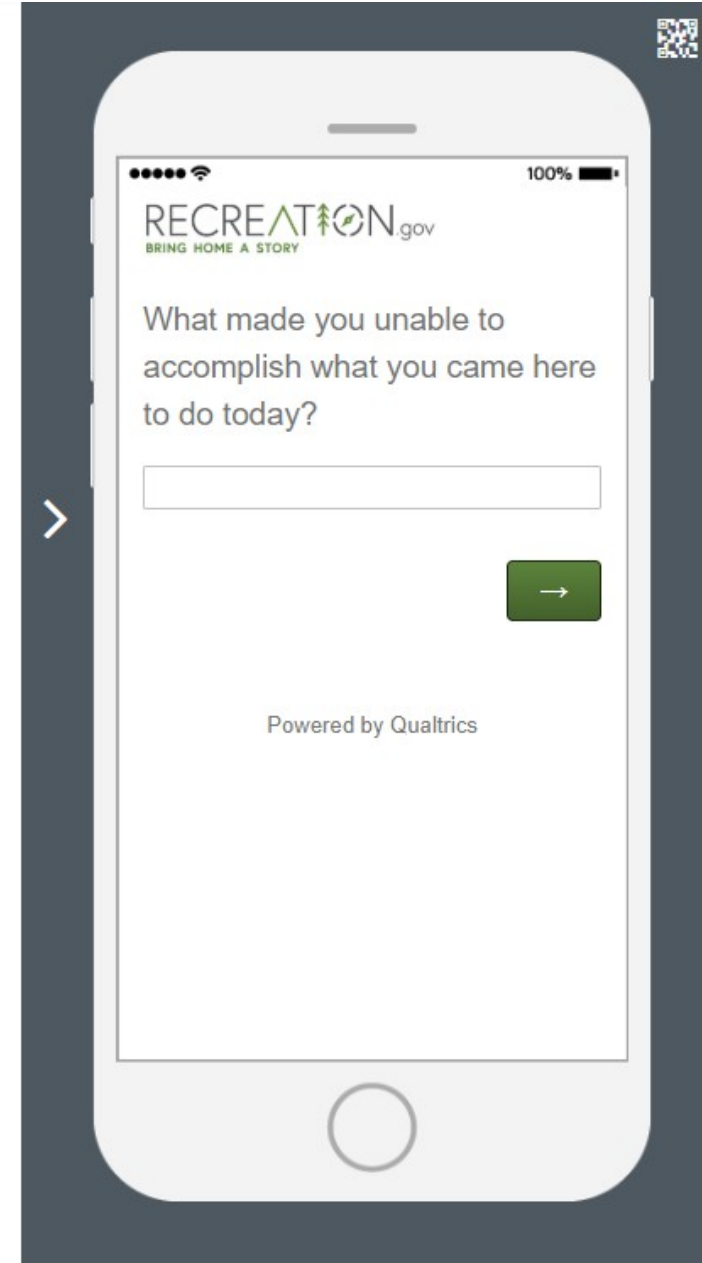

Q3:



I visit Recreation.gov...

This is my first visit

Every few months or less often

Monthly

Weekly

Several times a week

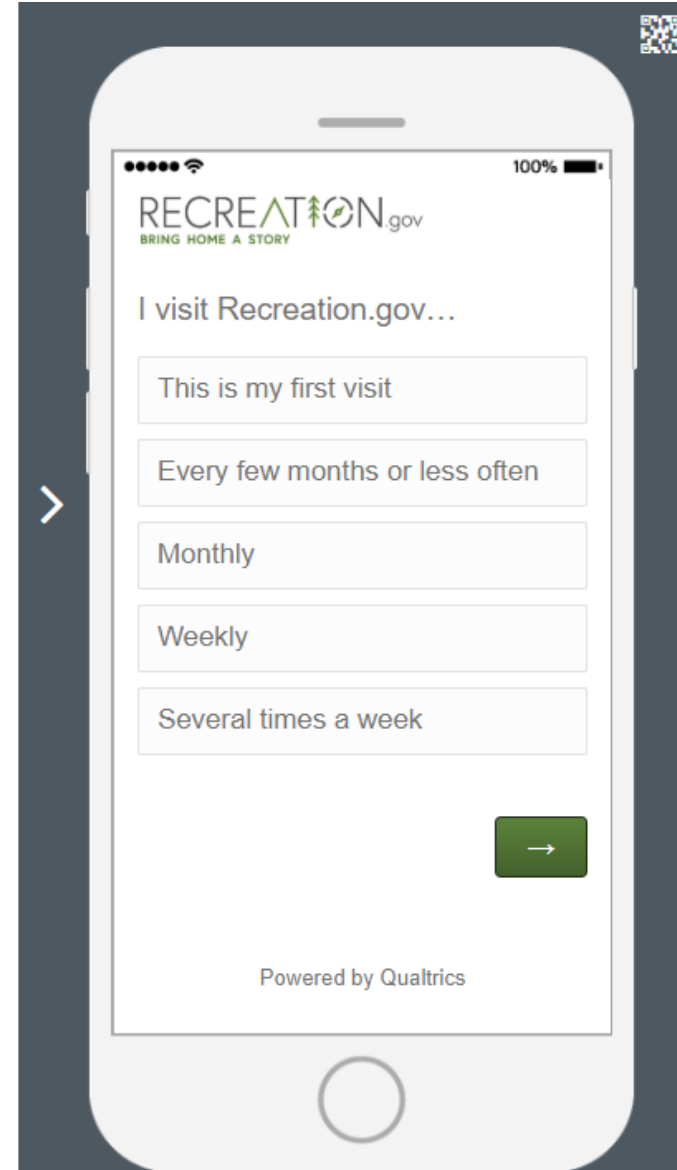

Q4:



On a scale from 0-10, how likely are you to recommend Recreation.gov to a friend or colleague?

Not at all likely

Extremely likely

0	1	2	3	4	5	6	7	8	9	10
---	---	---	---	---	---	---	---	---	---	----

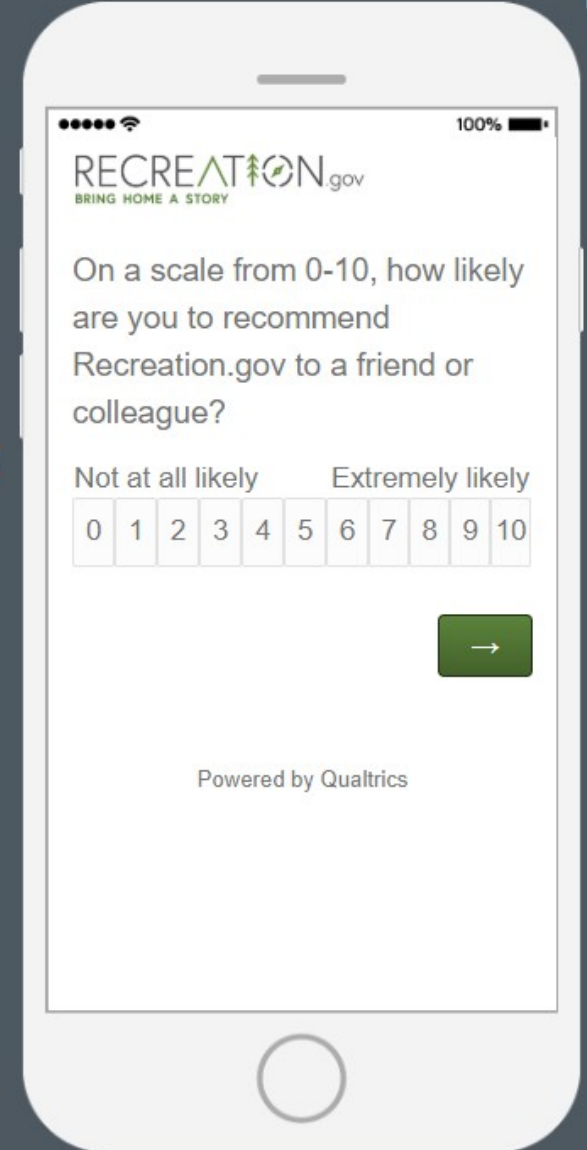

Q5:



If Recreation.gov could improve one thing what would that be?

